

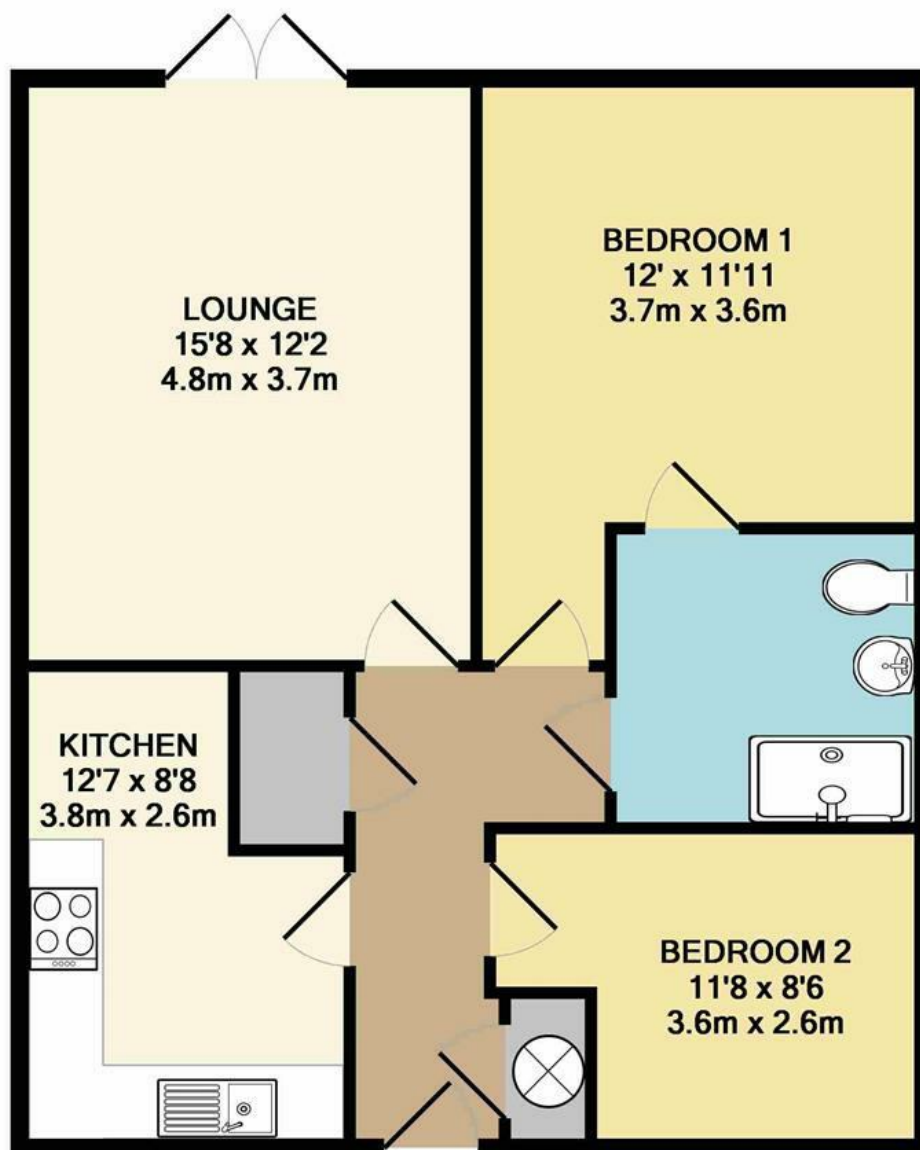

North Walsham Road | Norwich | NR12
 Guide £195,000

abbotFox



TOTAL APPROX. FLOOR AREA 687 SQ.FT. (63.9 SQ.M.)

Whilst every attempt has been made to ensure the accuracy of the floor plan contained here, measurements of doors, windows, rooms and any other items are approximate and no responsibility is taken for any error, omission, or mis-statement. This plan is for illustrative purposes only and should be used as such by any prospective purchaser. The services, systems and appliances shown have not been tested and no guarantee as to their operability or efficiency can be given
 Made with Metropix ©2019

| Energy Efficiency Rating | | |
|---|-------------------------|-----------|
| | Current | Potential |
| Very energy efficient - lower running costs | | |
| (92 plus) A | | |
| (81-91) B | | |
| (69-80) C | | |
| (55-68) D | | |
| (39-54) E | | |
| (21-38) F | | |
| (1-20) G | | |
| Not energy efficient - higher running costs | | |
| England & Wales | EU Directive 2002/91/EC | |

Disclaimer – In accordance with the Property Misdescriptions Act, the company gives notice that all descriptions, references to condition, necessary permissions for use and other details are given in good faith and believed to be correct, but any intending lessees do not rely on them as statements of fact, but must satisfy themselves by inspection or other means, as to their accuracy.



abbotFox presents this modern retirement bungalow let long term at £10,800 per annum.

This is one of 23 two and three-bedroom bungalows in a range of sizes and styles set on the edge of the well serviced village of Spixworth.

Accommodation comprises of a generous reception hall, fitted kitchens with integrated electric oven, gas hob, a washer dryer and a dishwasher. There is a modern room.

Outside, the property enjoys a private garden and parking.

Spixworth is a peaceful village just four miles north of the city of Norwich, it benefits from a post office, an active village hall, doctors surgery, dentist, several shops, two schools, a public house and a popular social club.

